

# How to connect to Libreview



## Sharing your Freestyle Libre 2 plus CGM data

### What is Libreview?

Libreview is a cloud-based webplatform where your healthcare team can log in to view your Freestyle Libre continuous glucose monitor (CGM) data. You can connect directly from your Freestyle LibreLink app or upload your Freestyle Libre 2 reader using a USB cable and computer.

Sharing your CGM data with your healthcare team means they can easily review your glucose levels and help you adjust your diabetes treatment and medications. Using Libreview can also help facilitate remote virtual or phone follow up. This means you can have more frequent follow up and less face to face appointments.

### Connecting to a practice from the Freestyle LibreLink app

Step 1. Open LibreLink app > select ☰ menu on top left

Step 2. Scroll down and select 'Connected apps' ☁️

Step 3. Next to Libreview select 'Connect' or 'Manage'

Step 4. Select 'connect to a practice'

Step 5. Enter practice ID: **accessaid**

Step 6. Select 'next'

Step 7. Confirm the practice > Select 'done'

Step 8. Select 'back to connected clinics' - all done!

# How to connect to Libreview

AOTEAROA  
DIABETES  
COLLECTIVE

Sharing your Freestyle Libre 2 plus CGM data



1. Open the Freestyle LibreLink app > select menu on top left

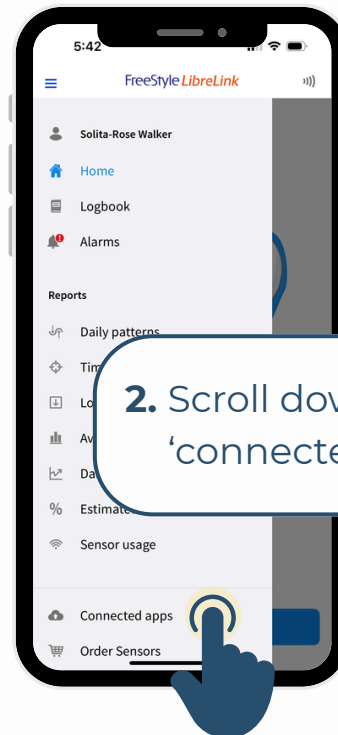

2. Scroll down > select 'connected apps'

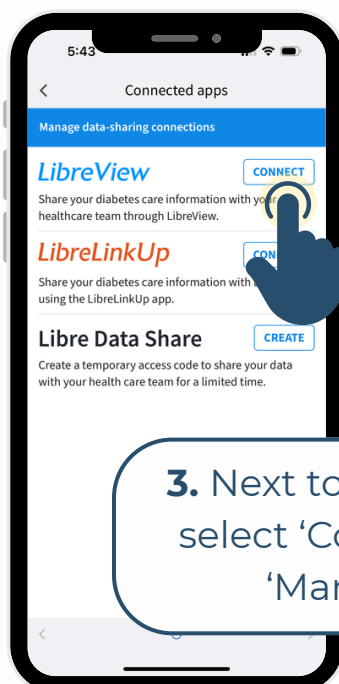

3. Next to Libreview select 'Connect' or 'Manage'

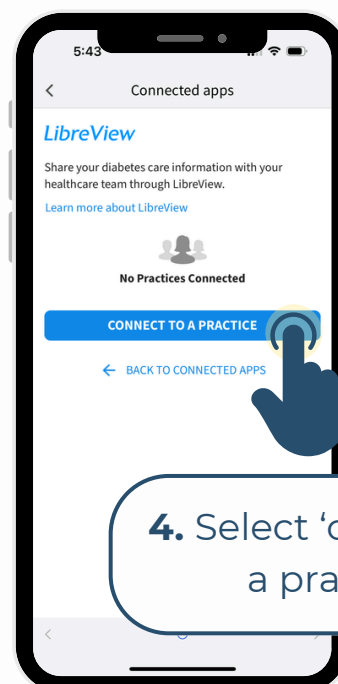

4. Select 'connect to a practice'

# How to connect to Libreview



Sharing your Freestyle Libre 2 plus CGM data

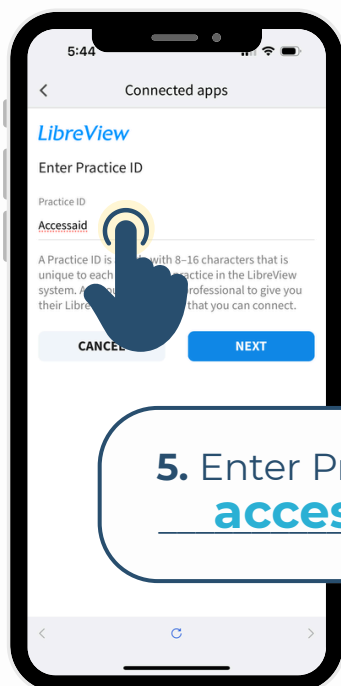

5. Enter Practice ID  
**accessaid**

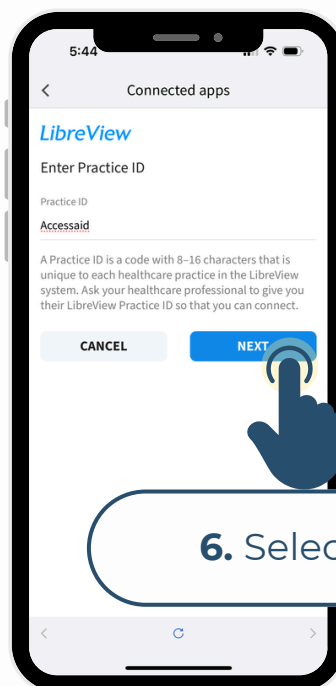

6. Select next

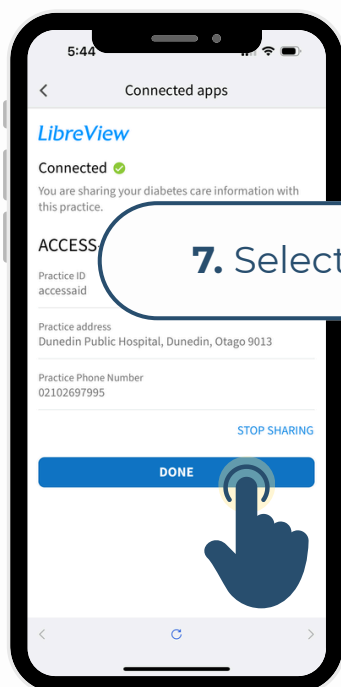

7. Select 'done'

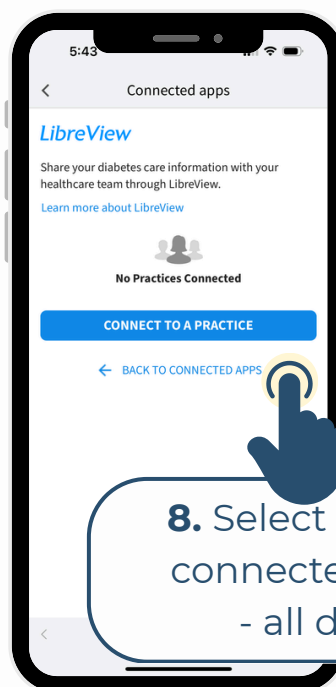

8. Select 'back to connected apps'  
- all done ✓